



# Archaeology at Durham



# Welcome to the Archaeology Department

Our job today is to convince you that what we offer you is **a world-leading opportunity to learn archaeological information and techniques from some of the best people in the field**

But more than that...

...a degree in Archaeology at Durham sets you up with **high level knowledge, life skills and experiences** to give you **a great basis for future employment prospects** and an appreciation of people, culture, history and the world around you that few other programmes offer.

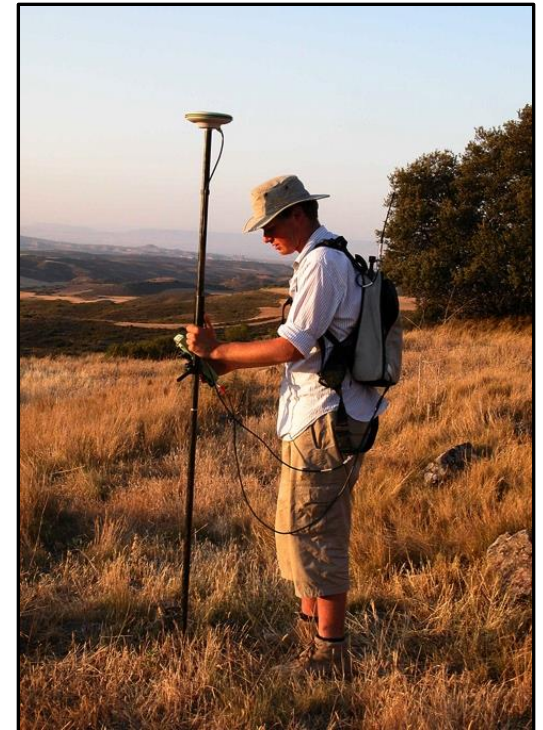



A scenic view of Durham Cathedral, a large Gothic building with two prominent towers, situated on a hill. The foreground is filled with dense green trees, and a river is visible at the bottom left. The sky is blue with some light clouds. The text "My Student Experience of Archaeology at Durham" is overlaid in white, centered on the image.

# My Student Experience of Archaeology at Durham

Amelie Brayshaw



# Academic experience

Recreation of  
horse armor  
excavated at  
Vindolanda  
Roman Fort.  
(photo by  
author)

Historical Archaeology BA (2023-2026)

Wide range of module choices.

Academic support available

Snail? ..... No! It is  
a fragment of a  
pottery duck head  
excavated at  
Buhen Fortress,  
Egypt. (Photo by  
Author)





Mortimer Wheeler would be proud!  
(photo by author)



Trench A team.  
(photo by author)



Post Medieval arrowhead excavated at  
Auckland Castle (photo by author).



Post Medieval key  
excavated at Auckland  
Castle (photo by author).

## Opportunities through the Department

Auckland  
Castle 2024

Zooarchaeology

Moldova 2025

# An outstanding centre of learning...

## 1st for Archaeology

The Times and  
Sunday Times  
Good  
University  
Guide 2024

## 4th

The Complete  
University  
Guide 2026

- Largest of the top two UK archaeology departments for research excellence (2021 REF)
- Prize winning books
- Excellence in Teaching Awards
- Chartered Institute for Field Archaeologists Accredited Professional training pathways
- Annual paid student placements in the profession

*"Durham Archaeology Department is the most rewarding and thrilling place I have ever been. The staff and students all work together to create a helpful environment where nobody feels like they're behind."* NSS respondent 2021

*"My department are fantastic/they are really good at communication and provide stimulating and diverse learning experiences."* NSS respondent 2020



## Athena Swan Silver Award

since  
December  
2022

## 6th in the world

QS World  
University  
Rankings by  
Subject 2025



# The Melsonby hoard (North Yorkshire) ~50 AD

14 chariots, cauldrons, fittings not far from the Iron Age oppidum at Stanwick



Faye (Level 2 Archaeology student: doing a placement with Archaeological Services Durham University at the time of excavation)







As of 2024-25

- 38 Academic Staff
  - 6 Technical Staff
  - 8 Professional Support Staff
  - 19 Postdoctoral researchers
  - 360 Undergraduate students
  - 150 Masters students
  - 103 Postgraduate research students
- + ASDU – our Archaeological Services Durham University contract archaeology team!



Our values?



We believe that inspiring our people to do outstanding things in Archaeology at Durham... enables Durham people to do outstanding things in the world.



What is  
Archaeology?



# ARCHAEOLOGY

Archaeology is a way of looking at the past through **physical remains** from the smallest (e.g. aDNA, isotopes, pollen grains) to the largest (e.g. entire landscapes)

We also work with written sources, oral history and other forms of evidence





Extensive in **time**

---

Archaeologists explore the earliest hominids and the very emergence of humanity – but they also explore the modern world (e.g. WWII) and everything in between





Extensive in **space**

We work locally, nationally and internationally.

Durham archaeologists are currently researching Britain, France, Italy, Spain, Croatia, Moldova, Brazil, Guinea-Bissau, Bermuda, China, Nepal, Tunisia, Egypt, Lebanon, Portugal and beyond





# We're interested in BIG questions.

- How did our species evolve?
- How did states support the investment needed to build their huge monuments?
- How did the health of different sectors of populations correspond to social circumstances and political policies in different periods and places?
- What was the impact of colonialism and Empire?





# But why does any of this matter?

- How did climate change influence the growth and decline of kingdoms and empires?
- It has been proposed that ‘the Celts’ were never really a people – the term was used by Roman authors to describe a myriad of different groups. Why should this matter to people?
- How should heritage in regions suffering conflict be protected?
- How has the health of populations shaped human history?





# How do we answer these questions?

We excavate, but we also survey, photograph, map, analyse, philosophise and interpret

Archaeology is a broad discipline ranging from **hard science** (aDNA, stable isotopes) to **humanities** (art history, history)

We work with historians, anthropologists, geographers, earth scientists, biologists, art historians, visual psychologist, classicists and *many others*





# Research-led learning and teaching





# What we do?

Research and training on five continents

Bhaktapur, Nepal,  
GPR survey



Saian Mountains, Siberia



Drežnica, Croatia



Borj Younga, South Tunisia





# Our Facilities

- aDNA
- Materials analysis
- Thermoluminescence
- Conservation
- Human Bioarchaeology & Forensics
- Isotopes
- Faunal and Botanical Remains
- Digital Imaging
- Museums
- Library
- World Heritage Site





# *Courses and structures*

## **Single Honours**

- BA (Hons), Archaeology (F400)
- BSc (Hons), Archaeology (F402)
- BA (Hons), Historical Archaeology (F411)
- BA (Hons), Archaeology and Ancient Civilizations (VQ48)

## **Joint Honours**

- BA (Hons), Archaeology and Ancient History (VF14)
- BA (Hons), Archaeology and Anthropology (LF64)

## **Combined Honours**





# BA (Hons), Archaeology (F400)

Presents a wide range of period and skills options

Students can either specialise or keep their studies broad





# BA Archaeology (F400)

## Level 1

- **3 core modules in Archaeology**
  - Archaeology in Britain; Archaeology Practicals; Applied Archaeological Methods
- **3 elective modules, at least 1 from Archaeology**
  - Cities in Antiquity; Medieval to Modern; Ancient Civilizations of the East; Discovering World Prehistory

## Level 2

- **3 core modules in Archaeology**
  - Professional Training; Developing Archaeological Research; Advanced Skills (single)
- **2 elective modules, at least 1 from Archaeology**
  - Prehistoric Europe; Becoming Roman; Archaeology of Medieval and Post-Medieval Britain; East Mediterranean in the Bronze Age; Ancient Mediterranean Civilisations- East & West
- **OR Advanced Skills (double)**
- **1 other module listed above or a module from another department**

## Level 3

- **4 core modules in Archaeology**
  - Dissertation (2 modules); Advanced Professional Training; Current Archaeology,
- **2 electives from a set of choices, with an option for 1 module in another department**
  - Specialized Aspects in Archaeology – (single or double)
  - Interpreting Heritage (Field Trip Abroad)
  - Climate Archaeology
  - Museum Representation
  - a module in another department



# BSc (Hons), Archaeology (F402)

More science focused but still providing a broad range of options

Introduces you to a wide range of scientific approaches for looking at the past:  
environmental archaeology,  
human/animal bone, aDNA,  
stable isotopes, materials  
analysis



The BSc has its own programme diverging from the BA route after the first term of Level 1.



# BA (Hons), Historical Archaeology (F411)

Focusing on the intersection between history and archaeology – exploring the medieval, post-medieval and modern world

Big questions: religious change, economies, industrialisation, slavery, colonialism and Empire





# BA (Hons), Archaeology and Ancient Civilizations (VQ48)

This course gives you a good overview of the world of archaeology, but also allows you to focus in particular on the great ancient civilisations of Europe, the Near East and Asia, including Ancient Greece and Rome, Egypt, India, Sri Lanka and Nepal.





# Joint Honours Degrees

## BA (Hons), Ancient History and Archaeology (VF14)

Taught across the Depts  
of Archaeology and  
Classics

Intersection of the  
classical world (Greece,  
Rome and beyond) and  
archaeology.

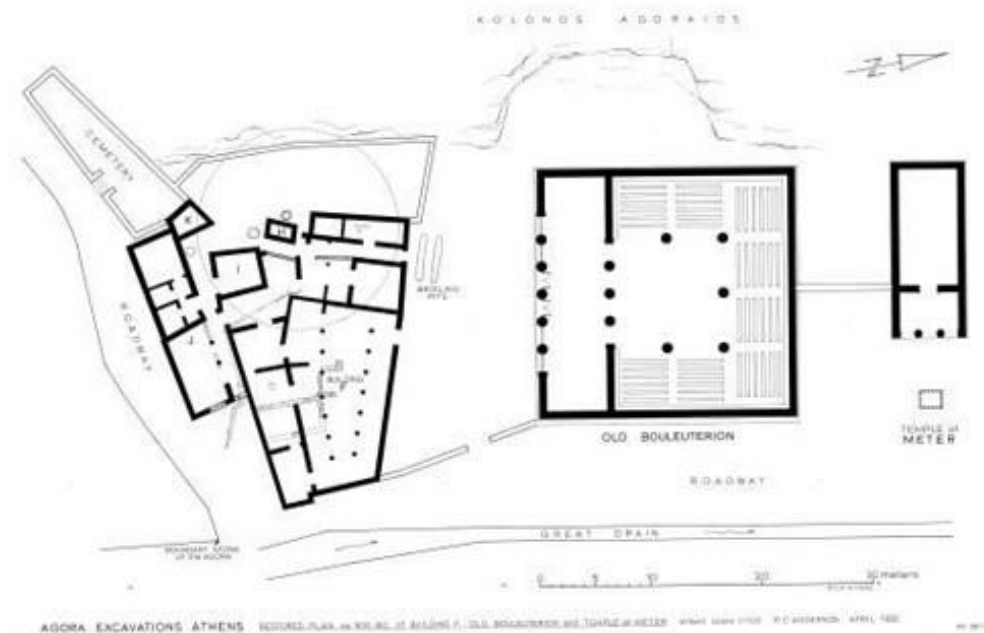



# BA (Hons), Anthropology and Archaeology (LF64)

Combines modules from the BA/BSc (Hons) Anthropology degrees and BA (Hons) Archaeology, providing a comprehensive understanding of humanity both past and present.





# Modules – what will you get to study?

## Cities in Antiquity, Level 1



- What makes a city in the ancient Mediterranean?
- What are the characteristics of urbanism?
- How do they change over time?
- Why are cities located where they are?

Case study cities:

- Rome
- Constantinople
- Athens
- Alexandria



# Ancient Civilizations of the East, Level 1

- Lectures
- Small-group tutorials
- Near East: Mesopotamia; Egypt; India/Pakistan: The Indus Valley
- Agriculture and the economic base
- State formation
- Elite control
- Communication and the development of writing
- Comparing Civilizations
- A computer test/1000-word essay on one civilization/  
1500-word essay from a range of option/ two-hour  
unseen exam





# Level 1 Field Training:

Learning with *Archaeological Services Durham University*

*BAJR Skills Passport*

NB. not currently available to  
Joint Honours students





# Advanced Professional Training

Opportunity to participate in excavations, museum projects and or research projects.



Early medieval palace, Northumberland, Prof Sarah Semple

Bibracte, France, Prof Tom Moore



# Level 2: Advanced Skills

In this practical skills-oriented module, students can choose two or four (depending on programme) from a list of options, such as:

- Material analysis
- Analysing Palaeolithic Stone Tools
- Experimental Approaches to Studying Palaeolithic art
- Geophysical Survey
- Geographic Information Systems (GIS)
- Gravestone Recording
- 3D technologies
- Ceramics Analysis
- Experimental Archaeobotany
- Inscriptions for Archaeologists
- Intro to DNA Analysis
- Osteoarchaeology
- Remote Sensing
- Roman and Medieval Glass
- Relational Databases
- Digital Heritage
- Stable Isotope Analysis





# Level 3: Specialized Aspects

Two or four options (depending on programme) from an extensive list of topics in which staff are research experts.

- Animal and Human Bones
- Bronze Age Britain
- Cultural Landscapes
- South Asian Archaeology
- Genetics
- Palaeolithic Britain
- Sex and Shopping
- The Ancient Near East
- The European Upper Palaeolithic
- Warlords and Holymen
- Heritage Landscapes of East Asia
- Climate Archaeology
- Roman Sculpture
- Greeks and Others
- Celts, Sacrifice and War
- Vikings, Fire and Ice
- Hunters and Gatherers
- Ancient Egypt
- Indian Ocean Trade
- Current Geoarchaeology
- Isotope Magic
- Trends in Human Bioarchaeology
- Medieval Landscapes
- Chinese Archaeology

## RESEARCH ARTICLE All Roads Lead to Rome: Exploring Human Migration to the Eternal City through Biochemistry of Skeletons from Two Imperial-Era Cemeteries (1st-3rd c AD)

Kristina Kilgroe<sup>1\*</sup>, Janet Montgomery<sup>2</sup>

<sup>1</sup> Department of Anthropology, University of West Florida, Pensacola, FL, United States of America,  
<sup>2</sup> Department of Archaeology, Durham University, Durham, United Kingdom

\* [kkilgroe@uwf.edu](mailto:kkilgroe@uwf.edu)



### Abstract

Migration within the Roman Empire occurred at multiple scales and was engaged voluntarily and involuntarily. Because of the lengthy tradition of classical studies, archaeological analyses must be fully contextualized within the bounds of history, material culture, and epigraphy. In order to assess migration to Rome within an updated archaeological framework, strontium isotope analysis was performed on 105 individuals from Imperial Rome—Casal Bertone and Castellaccio Europarco. A subset of 55 individuals

### OPEN ACCESS

**Citation:** Kilgroe K, Montgomery J (2016) All Roads Lead to Rome: Exploring Human Migration to the Eternal City through Biochemistry of Skeletons from Two Imperial-Era Cemeteries (1st-3rd c AD). PLoS ONE 11(2): e0147585. doi:10.1371/journal.pone.0147585

**Editor:** Luca Bondioli, Museo Nazionale Preistorico Etnografico "L. Pigorini", ITALY

**Received:** August 5, 2015

**Accepted:** January 6, 2016

**Published:** February 10, 2016

**Copyright:** © 2016 Kilgroe, Montgomery. This is an open access article distributed under the terms of the [Creative Commons Attribution License](https://creativecommons.org/licenses/by/4.0/), which permits unrestricted use, distribution, and reproduction in any medium, provided the original author and source are credited.

**Data Availability Statement:** All data have been made freely available at Figshare (DOI: [10.6084/m9.figshare.4686711](https://doi.org/10.6084/m9.figshare.4686711)).

**Funding:** Data collection in Rome and carbon and oxygen isotope analyses were funded by a Doctoral Dissertation Research Improvement Grant from the National Science Foundation (BCS-0622452) awarded to KK (<http://www.nsf.gov/div/index.jsp?div=bcf>). Strontium isotope analyses were funded by a Wenner Gren Dissertation Fieldwork Grant awarded to KK (<http://www.wennergren.org/programs/dissertation-fieldwork-grants/>). Internet

PLOS ONE | DOI:10.1371/journal.pone.0147585

## LOST LANDSCAPES of Palaeolithic Britain

edited by  
Mark White

with

Martin Bates, Matthew Pope, Danielle Schreve,  
Becky Scott, Andrew St. John, and Elizabeth Stafford

## THE ARCHAEOLOGY OF SOUTH ASIA

From the Indus to Asoka,  
c. 6500 BCE–200 CE

ROBIN CONINGHAM AND RUTH YOUNG





# What does a week look like?

## Sample first year weekly timetable for Arch&Ancient Civ

	Monday	Tuesday	Wednesday	Thursday	Friday	Saturday
9	Arch Pracs - Dawson			AiB tutorial		AiB or Arch Pracs Fieldtrip
10		CiA tutorial		AiB lecture - Calman		
11						
12	CiA lecture – Physics	Lives of Objects – Elvet Riverside	IAM tutorial		ACE tutorial	
13						
14					AiB tutorial	
15						
16		ACE lecture – Calman			IAM lecture - Chemistry	
17				Lives of Objects Seminar		
18						

- 5 hours lectures per week & 5 hours tutorial/seminar classes (but alternate weeks)
- 3 hours practical class (sometimes a day field trip – Saturdays)
- Academic advisor meeting/lab volunteering/Arch Soc/weekly seminars/research group seminars.....



# What does a week look like?

## Sample first year weekly timetable for Arch&Ancient Civ

	Monday	Tuesday	Wednesday	Thursday	Friday
9	Arch Pracs - Dawson				
10				AiB lecture - Calman	
11					
12	CiA lecture – Physics	Lives of Objects – Elvet Riverside			
13					
14					AiB tutorial
15					
16		ACE lecture – Calman			IAM lecture - Chemistry
17				Lives of Objects Seminar	
18					

- 5 hours lectures per week & 5 hours tutorial/seminar classes (but alternate weeks)
- 3 hours practical class (sometimes a day field trip – Saturdays)
- Academic advisor meeting/lab volunteering/Arch Soc/weekly seminars/research group seminars.....



# ALL our degrees offer the option of a year abroad

- Normally, you will complete the first two years of their Durham degree, then take your year abroad at a reputable institution of your choice.
- As long as you pass the assessment set at the host institution, you can return to Durham and carry on to the third year of your Durham degree.
- Only the Durham marks count towards your final degree classification.

- Freie Universität Berlin (Germany)
- University of Leiden (Netherlands)
- University of Bergen (Norway)
- Université de Bordeaux (France)
- Koç University (Istanbul, Turkey)
- University of Granada (Spain)





# ALL our degrees offer the option of a paid 1-year work placement

- Complete the first two years of Durham degree;
- Identify a professional placement offer (40 weeks paid employment):
- Undertake reflective exercises, poster and presentation;
- Return after 1-year to complete final year of degree



x6 Placements on offer annually with Archaeological Services Durham University

# Engaged, Supportive and Social Community

- Academic Advisors
- Mental Health Contacts
- First generation scholars group
- Parent/carers network
- Durham Archaeology Society (ArchSoc)





# Careers

## Exceptional employability.

Some c. 30% of graduates work in archaeology, heritage and related fields;

Around c. 30% more go into fields such as business, the City, journalism publishing etc;

And the remaining graduates enter into vast array of postgraduate training routes from conservation and museums-based programmes to teacher training and law conversions or enter directly into employment sectors such as education, the armed forces etc.

..Jun Hui Sim  
Cultural  
Heritage  
Officer at  
the George  
Town World  
Heritage  
Incorporated,  
Malaysia...



...Alexander Owen  
Captain in the  
Household  
Cavalry and  
commands the  
Blues & Royals  
Squadron in the  
Household  
Cavalry Mounted  
Regiment...

...Lauren Sewell  
Studying for a PhD  
at Bournemouth  
tracking 2 million  
years of vegetation  
changes experienced  
by hominins in  
southern Africa...



# Declaring Disabilities

---

Please do not feel afraid of declaring disabilities in your application and enrolment processes.

---

You will find a supportive community, with people of different skills sets and backgrounds working together.

---

Declaring disabilities can be useful information for understanding achievements relative to context in university applications.

---

You will never be discriminated against – it is immoral and illegal!





[enquiries.arch@durham.ac.uk](mailto:enquiries.arch@durham.ac.uk)  
Telephone +44 (0)191 334 1100  
[www.dur.ac.uk/archaeology/](http://www.dur.ac.uk/archaeology/)