

# Botanic Garden

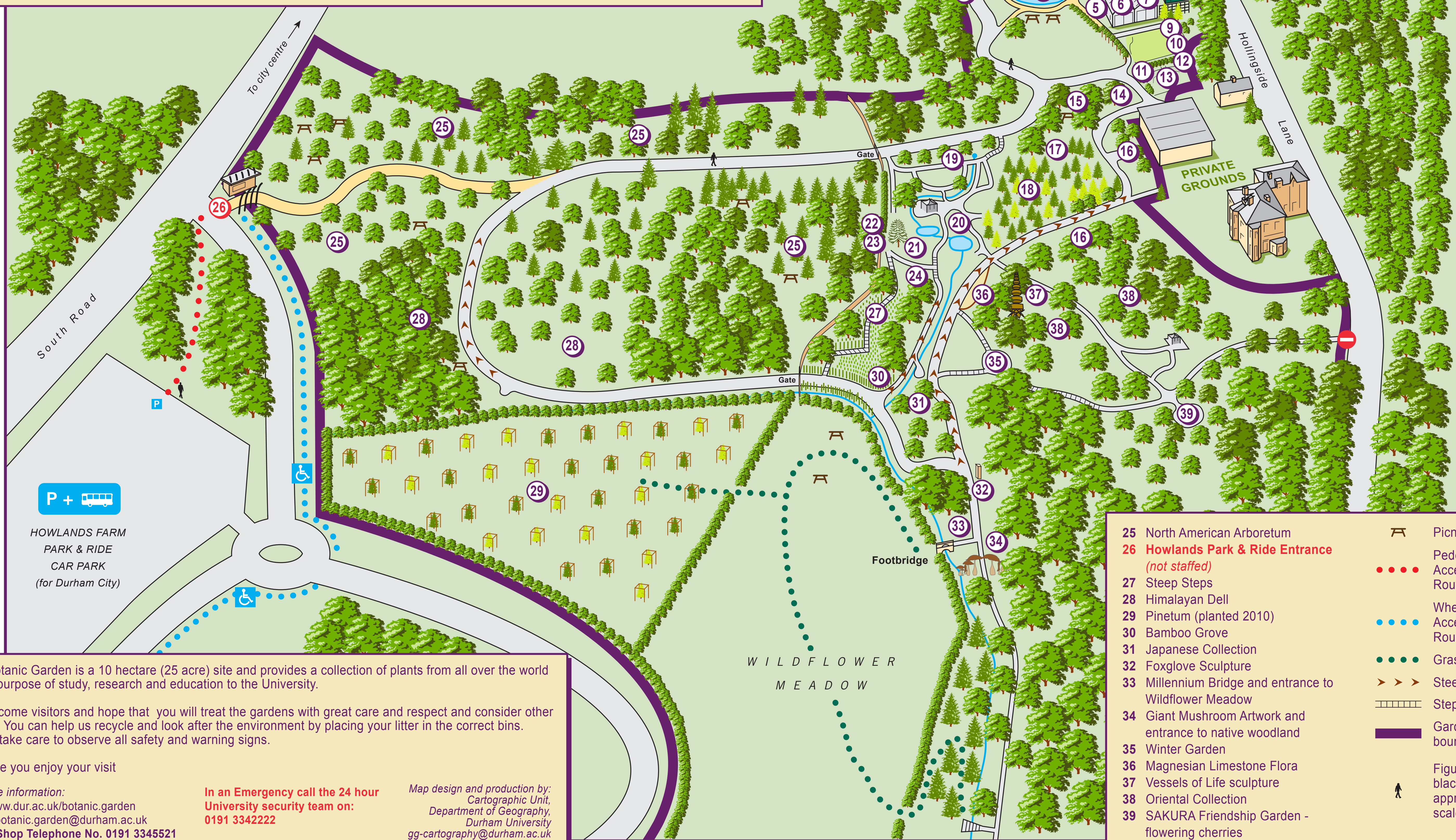

- |                                  |   |  |
|----------------------------------|---|--|
| 1 Visitor Centre and Coffee Shop | 9 Ethnobotany Collection                          | 17 Mutant Bed                                |
| 2 Children's Garden              | 10 Fossil Fern Bed                                | 18 Conifer Lawn                              |
| 3 Cornfield Annual Border        | 11 South African Collection                       | 19 Basil Bunting Inscription                 |
| 4 Prince Bishop's Garden         | 12 Plant History Bed                              | 20 Woodland and Pond Garden                  |
| 5 Grass Collection               | 13 Alpine Garden                                  | 21 Monkey Puzzle Tree and Chilean Collection |
| 6 Cactus House                   | 14 Australia, Tasmania and New Zealand Collection | 22 Apiary (Beehive) and Bug 'Hotel'          |
| 7 Tropical House                 | 15 Millennium Bug                                 | 23 Bird Hide and Wildlife Area               |
| 8 Conservatory and Tropical Bugs | 16 Research Plots                                 | 24 Woodland Copse Path                       |



- |   |   |
|---|---|
| 25 North American Arboretum                               | ⌘ Picnic tables                           |
| 26 Howlands Park & Ride Entrance (not staffed)            | ●●● Pedestrian Access Routes              |
| 27 Steep Steps  | ●●● Wheelchair Access Route               |
| 28 Himalayan Dell   | ●●● Grass Path                            |
| 29 Pinetum (planted 2010)                                 | ➤➤➤ Steep slopes                          |
| 30 Bamboo Grove   | ▤▤▤ Steps                                 |
| 31 Japanese Collection                                    | — Garden boundary                         |
| 32 Foxglove Sculpture                                     | ♀ Figures in black give approximate scale |
| 33 Millennium Bridge and entrance to Wildflower Meadow    |   |
| 34 Giant Mushroom Artwork and entrance to native woodland |   |
| 35 Winter Garden  |   |
| 36 Magnesian Limestone Flora                              |   |
| 37 Vessels of Life sculpture                              |   |
| 38 Oriental Collection                                    |   |
| 39 SAKURA Friendship Garden - flowering cherries          |   |

The Botanic Garden is a 10 hectare (25 acre) site and provides a collection of plants from all over the world for the purpose of study, research and education to the University.

We welcome visitors and hope that you will treat the gardens with great care and respect and consider other visitors. You can help us recycle and look after the environment by placing your litter in the correct bins. Please take care to observe all safety and warning signs.

We hope you enjoy your visit

For more information:  
 Web: [www.dur.ac.uk/botanic.garden](http://www.dur.ac.uk/botanic.garden)  
 e-mail: [botanic.garden@durham.ac.uk](mailto:botanic.garden@durham.ac.uk)  
 Coffee Shop Telephone No. 0191 3345521

In an Emergency call the 24 hour University security team on: 0191 3342222

Map design and production by:  
 Cartographic Unit,  
 Department of Geography,  
 Durham University  
[gg-cartography@durham.ac.uk](mailto:gg-cartography@durham.ac.uk)

**P +**   
 HOWLANDS FARM  
 PARK & RIDE  
 CAR PARK  
 (for Durham City)

WILDFLOWER  
 MEADOW

Footbridge

Gate

Gate

CAR PARK  
 (25 spaces)

Recycling & Compost Area

Entrance to University Woodland

Education Section

PRIVATE GROUNDS

Hollingside Lane

To city centre

South Road

# Botanic Garden

*Our garden is quite extensive and hilly in parts, however, most of it can easily be explored and we suggest the following routes which will take an hour or so. These routes avoid steps and most of the slopes in the garden.*

## Starting at the main Visitor Centre: ①

---

The Cornfield Annual border ③ and the Prince Bishop's garden ④ are your first points of interest.

Then visit the greenhouses ⑥ ⑦ ⑧ and the Ethnobotany collection ⑨ and Fossil Fern bed ⑩ on the lawn outside. Not far from here, passing the New Zealand, Australia and Tasmania collection ⑭, you will find a collection of plants from South Africa ⑪, a Plant History Bed ⑫ and our small Alpine garden ⑬.

Follow the path back towards the greenhouse bearing left down the slope, passing the 'Millennium Bug' on your left.

At the farm gate, the entrance to our North American arboretum ⑳ which is grazed by our rare breed sheep from November to February, turn left towards our magnificent monkey puzzle tree ㉑. In this area there is a bee hive and 'bug hotel' ㉒ and our bird hide ㉓. From here look out for the giant Chilean bamboo and continue across ponds and perhaps rest a while in the gazebo.

From here get your bearings and explore the woodland garden ㉔ behind the gazebo or make your way to our Oriental collection ㉖ and the 'Vessels of Life' sculpture ㉗.

## Starting at the main Visitor Centre: ㉘

---

Follow the path through our North American arboretum ㉙ which is grazed by our rare breed sheep from November to February, turn right towards our magnificent monkey puzzle tree ㉑. In this area there is a bee hive and 'bug hotel' ㉒ and our bird hide ㉓.

From here look out for the giant Chilean bamboo and continue across ponds and perhaps rest a while in the gazebo.

From here get your bearings and explore the woodland garden ㉔ behind the gazebo or make your way to our Oriental collection ㉖ and the 'Vessels of Life' sculpture ㉗. Head back to the farm gate through the woodland garden ㉔ and follow the path up the hill, passing the 'Millennium Bug' on your right. At the top of the hill, on the right, you can visit our New Zealand, Australia and Tasmania collection ⑭, a collection of plants from South Africa ⑪, a plant history bed ⑫ and our small Alpine garden ⑬. Over to the left you will find our greenhouses ⑥ ⑦ ⑧, the Ethnobotany collection ⑨ and Fossil Fern bed ⑩ on the lawn outside.

Further up from our greenhouse you will see our Visitor Centre. On the way there you can visit our Cornfield Annual border ③ and the Prince Bishop's garden ④.